

MR-028-032-2400

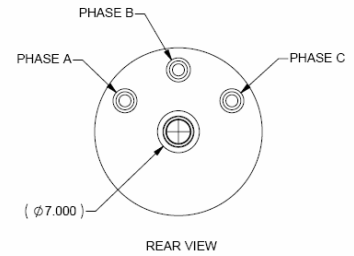

MR-028-032-2400	
Dimension (D x L)	28mm x 32mm
Shaft Diameter	3.17 mm
Weight	70g
Kv	2400 RPM/V
Io @ 8V	0.85A
Rm	36 mOhm
Pin	206W
I / Imax	23A / 28A
Vmax	25V

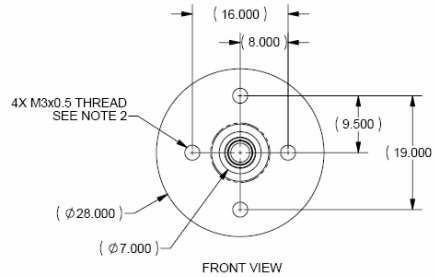
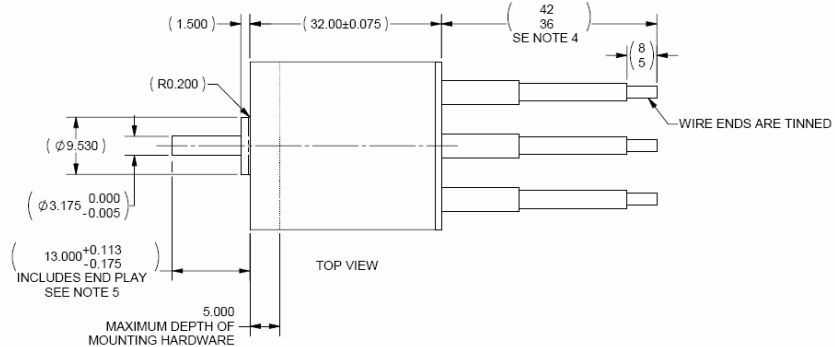

- ★ Designed in the USA by Medusa Research's experienced electric motor engineers
- ★ Created with cutting edge computer simulation and years of real-world testing
- ★ Two piece case construction for better endurance
- ★ Quality construction, materials and workmanship
- ★ High speed ball bearings rated at 60,000 RPM
- ★ Higher efficiency and power means better performance



Battery	Volts	Gearing	Prop	Amps	Prop RPM	Pitch Speed	Thrust	Power	Efficiency
3s LiPo	11.1 V	4.3:1	APC 15 x 8 E	24.2 A	4,804	36 MPH	56 oz	229 W	87.7%
8 Cell NiMH	9.6 V	4.3:1	APC 14 x 10 E	23.7 A	4,882	46 MPH	53 oz	228 W	87.9%
4s LiPo	11.1 V	4.3:1	APC 11 x 7 E	22.1 A	6,744	46 MPH	58 oz	284 W	89.3%
10 Cell NiMH	12 V	4.3:1	APC 13 x 8 E	23.1 A	6,233	47 MPH	58 oz	278 W	89.3%

Afterburner motors can provide more power, higher efficiency, and longer flight times than other brushless motors.